

welcome to your new home

# Whitburn Road, Bedworth

Warwickshire CV12

3 Bedroom Terrace Houses | **Plots 1, 2, 3 & 4**



## Kitchen

- Modern fitted kitchen
- Stainless steel oven, hood & extract
- Vinyl flooring
- Space for & fridge/freezer
- Integrated washing machine and dishwasher

## Bathroom

- Three piece white suite
- Complimentary wall tiling
- Downstairs WC
- Vinyl flooring

## General

- Located in market town of Bedworth in Warwickshire
- Two parking spaces per property
- Great Transport Links to Coventry, Birmingham, Nuneaton and Leamington Spa
- 10 Year build warranty
- Range of local amenities
- Intruder alarm

CGI shown is for Illustrations purposes only.

# Whitburn Road, Bedworth

Warwickshire CV12

3 Bedroom Terrace Houses | **Plots 1, 2, 3 & 4**

platform   
**home**  
OWNERSHIP

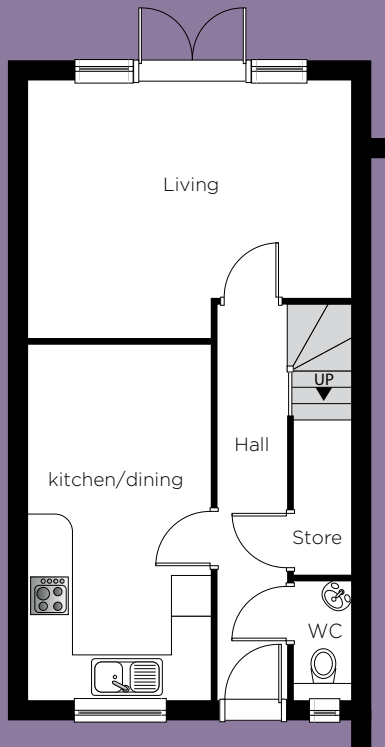

Ground Floor

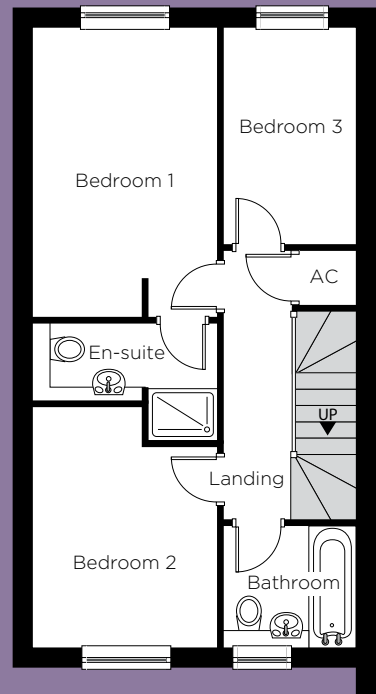

First Floor

**Please note:**  
This floorplan is for plots 1 & 3

Plots 2 & 4 will be the opposite floor layout

## Ground Floor

|                    |                 |   |                 |       |
|--------------------|-----------------|---|-----------------|-------|
| Kitchen/<br>dining | 5.20m<br>17' 1" | x | 2.68m<br>8' 9"  | (max) |
| Living             | 4.77m<br>15' 8" | x | 3.75m<br>12' 3" | (max) |

## First Floor

|          |                  |   |                |       |
|----------|------------------|---|----------------|-------|
| Bed 1    | 4.24m<br>13' 11" | x | 2.68m<br>8' 9" | (max) |
| Bed 2    | 3.48m<br>11' 5"  | x | 2.68m<br>8' 9" | (max) |
| Bed 3    | 3.18m<br>10' 5"  | x | 1.97m<br>6' 6" | (max) |
| En-Suite | 2.67m<br>8' 9"   | x | 1.71m<br>5' 7" | (max) |
| Bathroom | 1.91m<br>6' 3"   | x | 1.75m<br>5' 9" | (max) |

## Total Floor Area:

86.51m<sup>2</sup>/931.15 sq.ft

Kitchen layouts are indicative only. Please consult with Platform staff for specific plans, room dimensions and kitchen layouts. The information is for guidance only and is not to be relied on as statements or representations of fact and they do not make or give representation or warrant whatsoever and do not form part of any contract. All room measurements shown in metric first followed by imperial underneath.

welcome to your new home

# Whitburn Road, Bedworth

Warwickshire CV12

2 Bedroom Terrace Houses | **Plots 12, 13 & 14**

platform   
**home**  
O W N E R S H I P



## Kitchen

Modern fitted kitchen  
Stainless steel oven, hood & extract  
Vinyl flooring  
Space for & fridge/freezer  
Integrated washing machine  
and dishwasher

## Bathroom

Three piece white suite  
Complimentary wall tiling  
Downstairs WC  
Vinyl flooring

## General

Located in market town of  
Bedworth in Warwickshire  
Two parking spaces per property  
Great Transport Links to Coventry,  
Birmingham, Nuneaton and  
Leamington Spa  
10 Year build warranty  
Range of local amenities  
Intruder alarm

CGI shown is for Illustrations purposes only.

# Whitburn Road, Bedworth

Warwickshire CV12

2 Bedroom Terrace Houses | **Plots 12, 13 & 14**

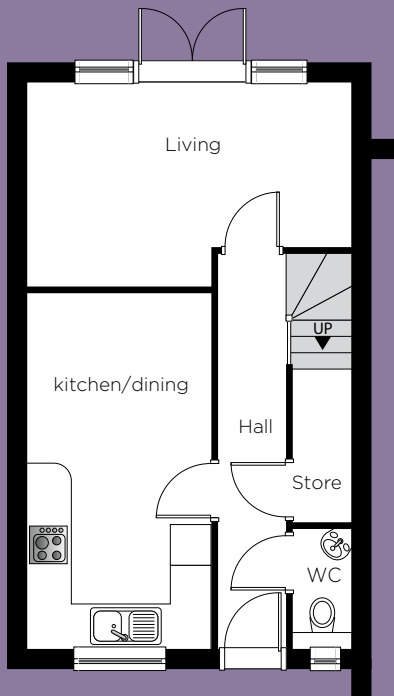

**Ground Floor**

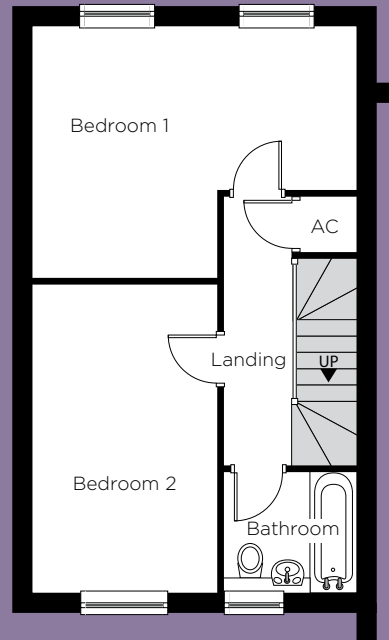

**First Floor**

**Please note:**  
This floorplan is for plots 12 & 13

Plot 14 will be the opposite floor layout

## Ground Floor

|                    |                 |   |                |       |
|--------------------|-----------------|---|----------------|-------|
| Kitchen/<br>dining | 5.20m<br>17' 1" | x | 2.68m<br>8' 9" | (max) |
| Living             | 4.79m<br>15' 9" | x | 2.96m<br>9' 8" | (max) |

## First Floor

|          |                 |   |                 |       |
|----------|-----------------|---|-----------------|-------|
| Bed 1    | 4.79m<br>15' 9" | x | 3.68m<br>12' 1" | (max) |
| Bed 2    | 4.50m<br>14' 9" | x | 2.68m<br>8' 9"  | (max) |
| Bathroom | 1.98m<br>6' 6"  | x | 1.72m<br>5' 8"  | (max) |

## Total Floor Area:

79.28m<sup>2</sup>/853.33 sq.ft

Kitchen layouts are indicative only. Please consult with Platform staff for specific plans, room dimensions and kitchen layouts. The information is for guidance only and is not to be relied on as statements or representations of fact and they do not make or give representation or warrant whatsoever and do not form part of any contract. All room measurements shown in metric first followed by imperial underneath.

welcome to your new home

# Whitburn Road, Bedworth

Warwickshire CV12

4 Bedroom End Terrace House | **Plot 5**

platform   
**home**  
O W N E R S H I P



## Kitchen

Modern fitted kitchen  
Stainless steel oven, hood & extract  
Vinyl flooring  
Space for & fridge/freezer  
Integrated washing machine  
and dishwasher

## Bathroom

Three piece white suite  
Complimentary wall tiling  
Downstairs WC  
Vinyl flooring

## General

Located in market town of  
Bedworth in Warwickshire  
Two parking spaces per property  
Great Transport Links to Coventry,  
Birmingham, Nuneaton and  
Leamington Spa  
10 Year build warranty  
Range of local amenities  
Intruder alarm

CGI shown is for Illustrations purposes only.

# Whitburn Road, Bedworth

Warwickshire CV12

4 Bedroom End Terrace House | Plot 5

platform   
**home**  
OWNERSHIP

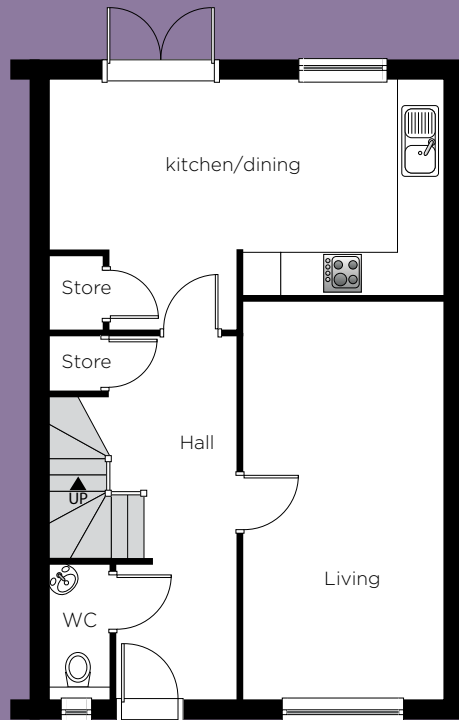

Ground Floor

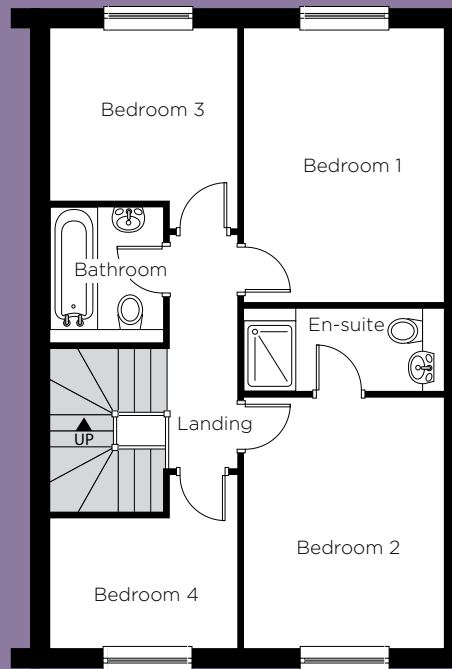

First Floor

## Ground Floor

|                    |                 |   |                 |       |
|--------------------|-----------------|---|-----------------|-------|
| Kitchen/<br>dining | 5.79m<br>19' 0" | x | 3.14m<br>10' 4" | (max) |
| Living             | 5.81m<br>19' 1" | x | 2.92m<br>9' 7"  | (max) |

## First Floor

|          |                  |   |                 |       |
|----------|------------------|---|-----------------|-------|
| Bed 1    | 3.95m<br>12' 11" | x | 2.92m<br>9' 7"  | (max) |
| Bed 2    | 3.68m<br>12' 1"  | x | 2.92m<br>9' 7"  | (max) |
| Bed 3    | 2.85m<br>9' 4"   | x | 2.76m<br>9' 0"  | (max) |
| Bed 4    | 2.76m<br>9' 0"   | x | 2.53m<br>8' 4"  | (max) |
| En-Suite | 2.92m<br>9' 7"   | x | 1.20m<br>3' 11" | (max) |
| Bathroom | 1.99m<br>6' 6"   | x | 1.68m<br>5' 6"  | (max) |

**Total Floor Area:**  
105.02m<sup>2</sup>/1130.38 sq.ft

Kitchen layouts are indicative only. Please consult with Platform staff for specific plans, room dimensions and kitchen layouts. The information is for guidance only and is not to be relied on as statements or representations of fact and they do not make or give representation or warrant whatsoever and do not form part of any contract. All room measurements shown in metric first followed by imperial underneath.



# Whitburn Road, Bedworth

Warwickshire CV12

Site plan



## Development

-  2 Bedroom Terrace House  
Plots 12, 13 & 14
-  3 Bedroom Terrace House  
Plots 1, 2, 3 & 4
-  4 Bedroom End Terrace House  
House Plot 5

Part of the **platform**  
housing group

For further details please contact our sales team on: **0121 788 7782** or email: [sales@platformhg.com](mailto:sales@platformhg.com)

Contact Us:  [www.platformhomeownership.com](http://www.platformhomeownership.com) |  [facebook.com/PlatformHomeOwnership](https://facebook.com/PlatformHomeOwnership)

 [twitter.com/PlatformNewHome](https://twitter.com/PlatformNewHome) |  [instagram.com/platformhomeownership](https://instagram.com/platformhomeownership)



# Whitburn Road, Bedworth

Warwickshire CV12

House prices for all plots available



## Houses available

| Plot | House Type              | Postal Address                              | Handover | 100% Price |  | Monthly Rent | Service Charge | Sold/Reserved |
|------|-------------------------|---|----------|------------|--|--------------|----------------|---------------|
| 1    | 3 Bed End Terrace House | Whitburn Road, Bedworth, Warwickshire CV12. |          |            |  |              |                |               |
| 2    | 3 Bed Mid Terrace House | Whitburn Road, Bedworth, Warwickshire CV12. |          |            |  |              |                |               |
| 3    | 3 Bed Mid Terrace House | Whitburn Road, Bedworth, Warwickshire CV12. |          |            |  |              |                |               |
| 4    | 3 Bed Mid Terrace House | Whitburn Road, Bedworth, Warwickshire CV12. |          |            |  |              |                |               |
| 5    | 4 Bed End Terrace House | Whitburn Road, Bedworth, Warwickshire CV12. |          |            |  |              |                |               |
| 12   | 2 Bed End Terrace House | Whitburn Road, Bedworth, Warwickshire CV12. |          |            |  |              |                |               |
| 13   | 2 Bed Mid Terrace House | Whitburn Road, Bedworth, Warwickshire CV12. |          |            |  |              |                |               |
| 14   | 2 Bed End Terrace House | Whitburn Road, Bedworth, Warwickshire CV12. |          |            |  |              |                |               |