



welcome to  
**Nicker Hill**

Keyworth • Nottingham



A modern development of  
2 & 3 bedroom new homes  
for shared ownership sale

welcome to your new home

# Nicker Hill, Keyworth

Nottingham, NG12 5SU

3 Bedroom Terrace | **Plots 29, 30, 31 & 32**



## Kitchen

Contemporary kitchen cupboards  
Stainless steel oven,  
hob and extractor  
Vinyl flooring  
Space for washing machine  
and fridge/freezer

## Bathroom

Three piece white suite  
Family bathroom  
Complimentary wall tiling  
Downstairs WC  
Vinyl flooring

## General

Located in the village of Keyworth  
Range of local amenities  
Excellent transport links  
Allocated parking space  
10 year build warranty  
Turfed rear garden  
Complimentary carpets

CGI shown is for Illustrations purposes only.

# Nicker Hill, Keyworth

Nottingham, NG12 5SU

3 Bedroom Terrace | **Plots 29, 30, 31 & 32**

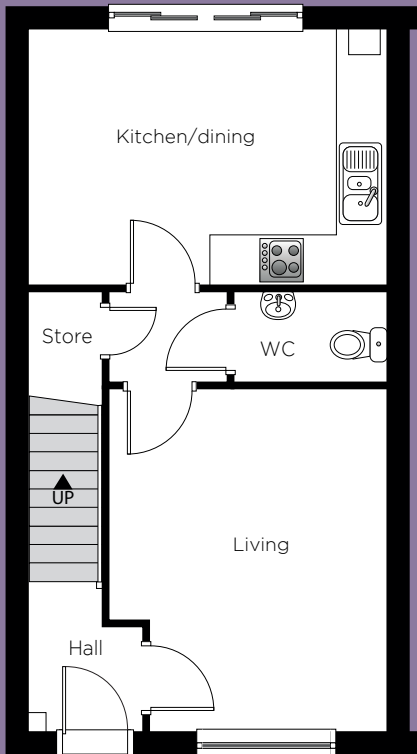

Ground Floor

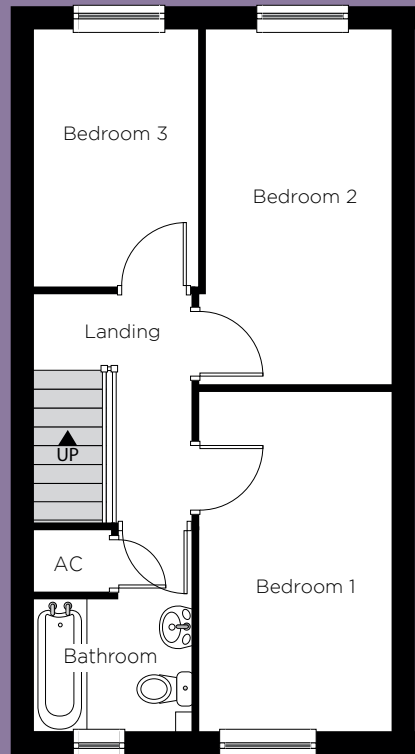

First Floor

**Please note:**  
Some plots will be the opposite floor layout to shown.

## Ground Floor

Kitchen/ dining	4.63m 15' 2"	x	3.34m 10' 11"	(max)
Living	4.45m 14' 7"	x	3.59m 11' 9"	(max)

## First Floor

Bed 1	4.42m 14' 6"	x	2.51m 8' 3"	(max)
Bed 2	4.60m 15' 1"	x	2.51m 8' 3"	(max)
Bed 3	3.35m 10' 12"	x	2.14m 7' 0"	(max)
Bathroom	2.06m 6' 9"	x	1.74m 5' 9"	(max)

## Total Floor Area:

84.10m<sup>2</sup>/905.23 sq.ft

Kitchen layouts are indicative only. Please consult with Platform staff for specific plans, room dimensions and kitchen layouts. The information is for guidance only and is not to be relied on as statements or representations of fact and they do not make or give representation or warrant whatsoever and do not form part of any contract. All room measurements shown in metric first followed by imperial underneath.

welcome to your new home

# Nicker Hill, Keyworth

Nottingham, NG12 5SU

2 Bedroom Terrace | **Plots 33, 34, 35 & 35**



## Kitchen

Contemporary kitchen cupboards  
Stainless steel oven,  
hob and extractor  
Vinyl flooring  
Space for washing machine  
and fridge/freezer

## Bathroom

Three piece white suite  
Family bathroom  
Complimentary wall tiling  
Downstairs WC  
Vinyl flooring

## General

Located in the village of Keyworth  
Range of local amenities  
Excellent transport links  
Allocated parking space  
10 year build warranty  
Turfed rear garden  
Complimentary carpets

CGI shown is for Illustrations purposes only.

# Nicker Hill, Keyworth

Nottingham, NG12 5SU

2 Bedroom Terrace | **Plots 33, 34, 35 & 35**

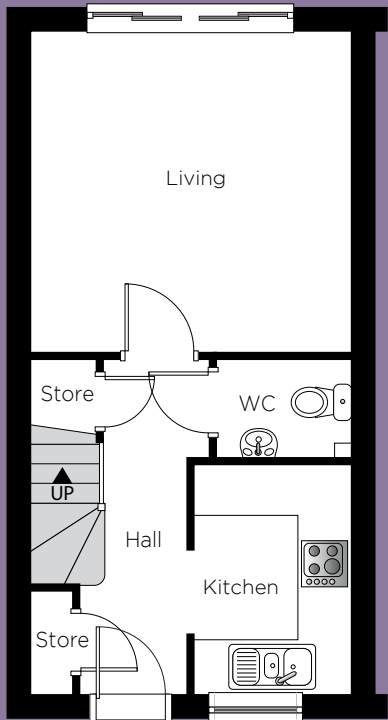

Ground Floor

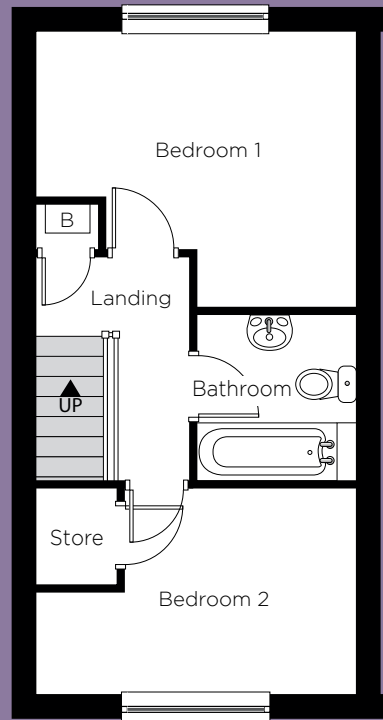

First Floor

**Please note:**  
Some plots will be the opposite floor layout to shown.

## Ground Floor

Kitchen	2.80m	x	1.92m (max)
	9' 2"	x	6' 3" (max)

Living	3.91m	x	3.91m (max)
	12' 10"	x	12' 10" (max)

## First Floor

Bed 1	3.91m	x	3.37m (max)
	12' 10"	x	11' 1" (max)

Bed 2	3.91m	x	2.52m (max)
	12' 10"	x	8' 3" (max)

Bathroom	2.00m	x	1.94m (max)
	6' 7"	x	6' 4" (max)

## Total Floor Area:

63.04m<sup>2</sup>/678.40 sq.ft

Kitchen layouts are indicative only. Please consult with Platform staff for specific plans, room dimensions and kitchen layouts. The information is for guidance only and is not to be relied on as statements or representations of fact and they do not make or give representation or warrant whatsoever and do not form part of any contract. All room measurements shown in metric first followed by imperial underneath.

welcome to your new home

# Nicker Hill, Keyworth

Nottingham, NG12 5SU

3 Bedroom Semi-Detached | **Plots 41 & 42**



## Kitchen

Contemporary kitchen cupboards  
Stainless steel oven,  
hob and extractor  
Vinyl flooring  
Space for washing machine  
and fridge/freezer

## Bathroom

Three piece white suite  
Family bathroom  
Complimentary wall tiling  
Downstairs WC  
Vinyl flooring

## General

Located in the village of Keyworth  
Range of local amenities  
Excellent transport links  
Allocated parking space  
10 year build warranty  
Turfed rear garden  
Complimentary carpets

CGI shown is for Illustrations purposes only.

# Nicker Hill, Keyworth

Nottingham, NG12 5SU

3 Bedroom Semi-Detached | **Plots 41 & 42**

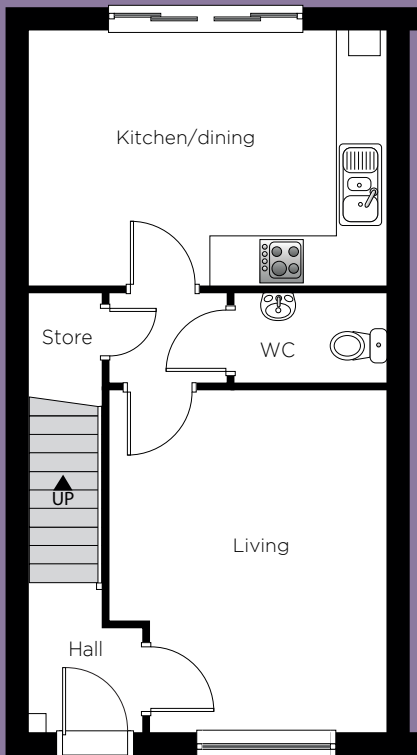

Ground Floor

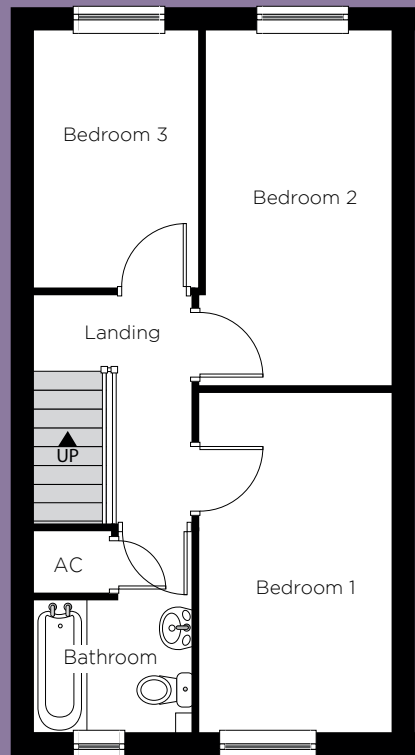

First Floor

**Please note:**  
Some plots will be the opposite floor layout to shown.

## Ground Floor

Kitchen/ dining	4.63m 15' 2"	x	3.34m 10' 11"	(max)
Living	4.45m 14' 7"	x	3.59m 11' 9"	(max)

## First Floor

Bed 1	4.42m 14' 6"	x	2.51m 8' 3"	(max)
Bed 2	4.60m 15' 1"	x	2.51m 8' 3"	(max)
Bed 3	3.35m 10' 12"	x	2.14m 7' 0"	(max)
Bathroom	2.06m 6' 9"	x	1.74m 5' 9"	(max)

## Total Floor Area:

84.10m<sup>2</sup>/905.23 sq.ft

Kitchen layouts are indicative only. Please consult with Platform staff for specific plans, room dimensions and kitchen layouts. The information is for guidance only and is not to be relied on as statements or representations of fact and they do not make or give representation or warrant whatsoever and do not form part of any contract. All room measurements shown in metric first followed by imperial underneath.

# Nicker Hill, Keyworth



Nottingham, NG12 5SU

Site plan

platform   
**home**  
OWNERSHIP



## Development

-  3 Bedroom Terrace houses  
plots 29, 30, 31 & 32
-  2 Bedroom terrace houses  
Plots 33, 34, 35 & 36
-  3 Bedroom Semi-Detached  
houses plots 41 & 42

Part of the **platform**  
 housing group

For further details please contact our sales team on: **0333 200 7304** or email: [sales@platformhg.com](mailto:sales@platformhg.com)

**Contact Us:**  [www.platformhomeownership.com](http://www.platformhomeownership.com) |  [facebook.com/PlatformHomeOwnership](https://facebook.com/PlatformHomeOwnership)  
 [twitter.com/PlatformNewHome](https://twitter.com/PlatformNewHome) |  [instagram.com/platformhomeownership](https://instagram.com/platformhomeownership)



# Nicker Hill, Keyworth

Nottingham, NG12 5SU

House prices for all plots available



## Houses available

Plot	House Type	Postal Address	Handover	100% Price	35% Share Value	Monthly Rent	Service Charge	Sold/Reserved
29	3 Bedroom End -Terrace House	10 Richards Place Keyworth Nottingham NG12 5SU.	June 2023	£277,500	£97,125	£413.36	TBC	
30	3 Bedroom Mid -Terrace House	11 Richards Place Keyworth Nottingham NG12 5SU.	June 2023	£275,000	£96,250	£409.64	TBC	
31	3 Bedroom Mid -Terrace House	12 Richards Place Keyworth Nottingham NG12 5SU.	June 2023	£275,000	£96,250	£409.64	TBC	
32	3 Bedroom End -Terrace House	13 Richards Place Keyworth Nottingham NG12 5SU.	June 2023	£277,500	£97,125	£413.36	TBC	
33	2 Bedroom End -Terrace House	14 Richards Place Keyworth Nottingham NG12 5SU.	June 2023	£251,950	£88,183	£375.30	TBC	
34	2 Bedroom Mid -Terrace House	15 Richards Place Keyworth Nottingham NG12 5SU.	June 2023	£250,000	£87,500	£372.40	TBC	
35	2 Bedroom Mid -Terrace House	16 Richards Place Keyworth Nottingham NG12 5SU.	June 2023	£250,000	£87,500	£372.40	TBC	
36	2 Bedroom End -Terrace House	17 Richards Place Keyworth Nottingham NG12 5SU.	June 2023	£251,950	£88,183	£375.30	TBC	
41	3 Bedroom Semi-Detached House	5 Street Close Keyworth Nottingham NG12 5SU.	November 2023	£280,000	£98,000	£417.08	TBC	
42	3 Bedroom Semi-Detached House	6 Street Close Keyworth Nottingham NG12 5SU.	November 2023	£280,000	£98,000	£417.08	TBC	

For further details please contact our sales team on: **0333 200 7304** or email: [sales@platformhg.com](mailto:sales@platformhg.com)

**Contact Us:**  [www.platformhomeownership.com](http://www.platformhomeownership.com) |  [facebook.com/PlatformHomeOwnership](https://facebook.com/PlatformHomeOwnership)

 [twitter.com/PlatformNewHome](https://twitter.com/PlatformNewHome) |  [instagram.com/platformhomeownership](https://instagram.com/platformhomeownership)

For details contact our sales team  
on **0333 200 7304**  
or email: **sales@platformhg.com**

**Contact Us:**



[www.platformhomeownership.com](http://www.platformhomeownership.com)



[facebook.com/PlatformHomeOwnership](https://facebook.com/PlatformHomeOwnership)



[twitter.com/PlatformNewHome](https://twitter.com/PlatformNewHome)



[instagram.com/platformhomeownership](https://instagram.com/platformhomeownership)

Scheme administered by Platform Housing Group  
1700 Solihull Parkway, Birmingham Business Park, Solihull, B37 7YD.

Part of the **platform**  
housing group