



welcome to
Nicker Hill

Keyworth • Nottingham



A modern development of
2 & 3 bedroom new homes
for shared ownership sale

welcome to your new home

Nicker Hill, Keyworth

Nottingham, NG12 5SU

3 Bedroom Terrace | **Plots 30 & 31**

platform 
home
O W N E R S H I P



Kitchen

Contemporary kitchen cupboards
Stainless steel oven,
hob and extractor
Vinyl flooring
Space for washing machine
and fridge/freezer

Bathroom

Three piece white suite
Family bathroom
Complimentary wall tiling
Downstairs WC
Vinyl flooring

General

Located in the village of Keyworth
Range of local amenities
Excellent transport links
Allocated parking space
10 year build warranty
Turfed rear garden
Complimentary carpets

CGI shown is for Illustrations purposes only.

Nicker Hill, Keyworth

Nottingham, NG12 5SU

3 Bedroom Terrace | **Plots 30 & 31**

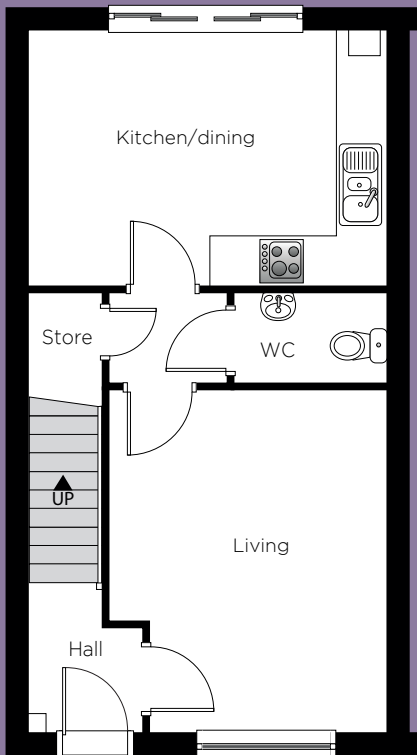

Ground Floor

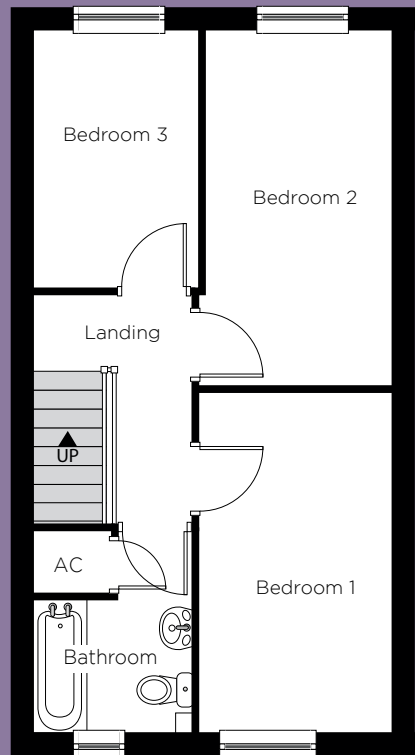

First Floor

Please note:
Some plots will be the opposite floor layout to shown.

Ground Floor

Kitchen/ dining	4.63m 15' 2"	x	3.34m 10' 11"	(max)
Living	4.45m 14' 7"	x	3.59m 11' 9"	(max)

First Floor

Bed 1	4.42m 14' 6"	x	2.51m 8' 3"	(max)
Bed 2	4.60m 15' 1"	x	2.51m 8' 3"	(max)
Bed 3	3.35m 10' 12"	x	2.14m 7' 0"	(max)
Bathroom	2.06m 6' 9"	x	1.74m 5' 9"	(max)

Total Floor Area:

84.10m²/905.23 sq.ft

Kitchen layouts are indicative only. Please consult with Platform staff for specific plans, room dimensions and kitchen layouts. The information is for guidance only and is not to be relied on as statements or representations of fact and they do not make or give representation or warrant whatsoever and do not form part of any contract. All room measurements shown in metric first followed by imperial underneath.

welcome to your new home

Nicker Hill, Keyworth

Nottingham, NG12 5SU

2 Bedroom Terrace | **Plots 34, 35, 36, 64, 65, 66 & 67**



Kitchen

Contemporary kitchen cupboards
Stainless steel oven,
hob and extractor
Vinyl flooring
Space for washing machine
and fridge/freezer

Bathroom

Three piece white suite
Family bathroom
Complimentary wall tiling
Downstairs WC
Vinyl flooring

General

Located in the village of Keyworth
Range of local amenities
Excellent transport links
Allocated parking space
10 year build warranty
Turfed rear garden
Complimentary carpets

CGI shown is for Illustrations purposes only.

Nicker Hill, Keyworth

Nottingham, NG12 5SU

2 Bedroom Terrace | **Plots 34, 35, 36, 64, 65, 66 & 67**

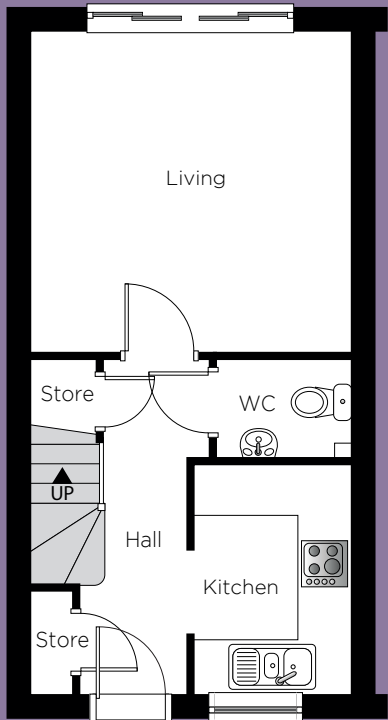

Ground Floor

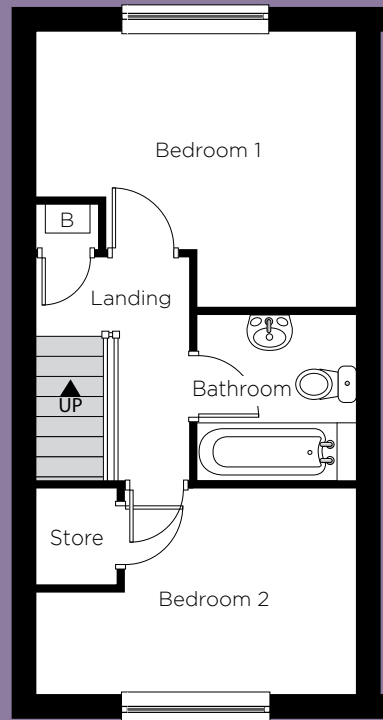

First Floor

Please note:
Some plots will be the opposite floor layout to shown.

Ground Floor

Kitchen	2.80m 9' 2"	x	1.92m (max) 6' 3" (max)
Living	3.91m 12' 10"	x	3.91m (max) 12' 10" (max)

First Floor

Bed 1	3.91m 12' 10"	x	3.37m (max) 11' 1" (max)
Bed 2	3.91m 12' 10"	x	2.52m (max) 8' 3" (max)
Bathroom	2.00m 6' 7"	x	1.94m (max) 6' 4" (max)

Total Floor Area:
63.04m²/678.40 sq.ft

Kitchen layouts are indicative only. Please consult with Platform staff for specific plans, room dimensions and kitchen layouts. The information is for guidance only and is not to be relied on as statements or representations of fact and they do not make or give representation or warrant whatsoever and do not form part of any contract. All room measurements shown in metric first followed by imperial underneath.

welcome to your new home

Nicker Hill, Keyworth

Nottingham, NG12 5SU

3 Bedroom Semi-Detached | **Plots 41 & 42**

platform 
home
OWNERSHIP



Kitchen

Contemporary kitchen cupboards
Stainless steel oven,
hob and extractor
Vinyl flooring
Space for washing machine
and fridge/freezer

Bathroom

Three piece white suite
Family bathroom
Complimentary wall tiling
Downstairs WC
Vinyl flooring

General

Located in the village of Keyworth
Range of local amenities
Excellent transport links
Allocated parking space
10 year build warranty
Turfed rear garden
Complimentary carpets

CGI shown is for Illustrations purposes only.

Nicker Hill, Keyworth

Nottingham, NG12 5SU

3 Bedroom Semi-Detached | **Plots 41 & 42**

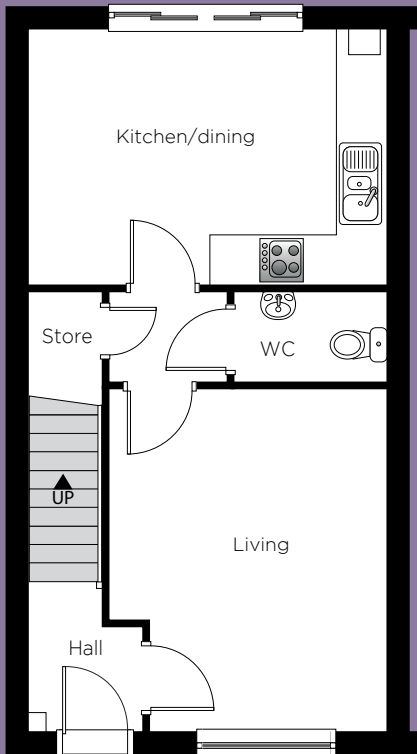

Ground Floor

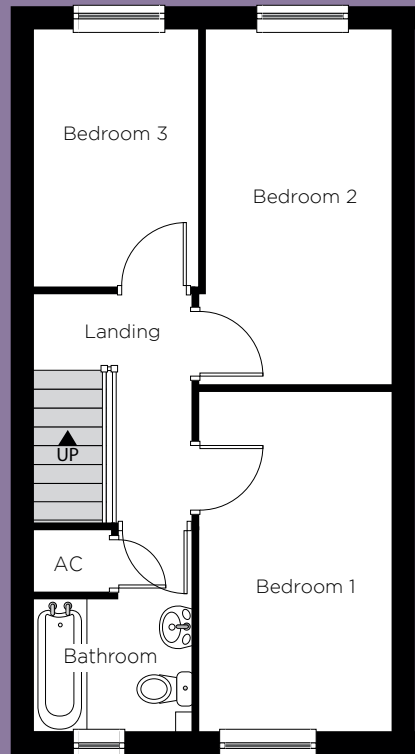

First Floor

Please note:
Some plots will be the opposite floor layout to shown.

Ground Floor

Kitchen/ dining	4.63m 15' 2"	x	3.34m 10' 11"	(max)
Living	4.45m 14' 7"	x	3.59m 11' 9"	(max)

First Floor

Bed 1	4.42m 14' 6"	x	2.51m 8' 3"	(max)
Bed 2	4.60m 15' 1"	x	2.51m 8' 3"	(max)
Bed 3	3.35m 10' 12"	x	2.14m 7' 0"	(max)
Bathroom	2.06m 6' 9"	x	1.74m 5' 9"	(max)

Total Floor Area:

84.10m²/905.23 sq.ft

Kitchen layouts are indicative only. Please consult with Platform staff for specific plans, room dimensions and kitchen layouts. The information is for guidance only and is not to be relied on as statements or representations of fact and they do not make or give representation or warrant whatsoever and do not form part of any contract. All room measurements shown in metric first followed by imperial underneath.

Nicker Hill, Keyworth



Nottingham, NG12 5SU

Site plan

platform 
home
OWNERSHIP



Development

-  3 Bedroom Terrace houses plots 30 & 31
-  2 Bedroom terrace houses Plots 34, 35, 36, 64, 65, 66 & 67
-  3 Bedroom Semi-Detached houses plots 41 & 42

Part of the **platform**
 housing group

For further details please contact our sales team on: **0333 200 7304** or email: sales@platformhg.com

Contact Us:  www.platformhomeownership.com |  facebook.com/PlatformHomeOwnership

 twitter.com/PlatformNewHome |  instagram.com/platformhomeownership

Nicker Hill, Keyworth

Nottingham, NG12 5SU

House prices for all plots available



Houses available

Plot	House Type	Postal Address	Handover	100% Price	35% Share Value	Monthly Rent	Service Charge	Sold/Reserved
30	3 Bedroom Mid -Terrace House	11 Richards Place Keyworth Nottingham NG12 5SU.	June 2023	£275,000	£96,250	£409.64	£25.33	
31	3 Bedroom Mid -Terrace House	12 Richards Place Keyworth Nottingham NG12 5SU.	June 2023	£275,000	£96,250	£409.64	£25.33	
34	2 Bedroom Mid -Terrace House	15 Richards Place Keyworth Nottingham NG12 5SU.	June 2023	£250,000	£87,500	£372.40	£25.33	
35	2 Bedroom Mid -Terrace House	16 Richards Place Keyworth Nottingham NG12 5SU.	June 2023	£250,000	£87,500	£372.40	£25.33	
36	2 Bedroom End -Terrace House	17 Richards Place Keyworth Nottingham NG12 5SU.	June 2023	£251,950	£88,183	£375.30	£25.33	
41	3 Bedroom Semi-Detached House	5 Street Close Keyworth Nottingham NG12 5SU.	April 2024	£280,000	£98,000	£417.08	£25.33	
42	3 Bedroom Semi-Detached House	6 Street Close Keyworth Nottingham NG12 5SU.	April 2024	£280,000	£98,000	£417.08	£25.33	
64	2 Bedroom End -Terrace House	18 Street Close Keyworth Nottingham NG12 5SU.	June 2024	£251,950	£88,183	£375.30	£25.33	
65	2 Bedroom Mid -Terrace House	19 Street Close Keyworth Nottingham NG12 5SU.	June 2024	£250,000	£87,500	£372.40	£25.33	
66	2 Bedroom Mid -Terrace House	20 Street Close Keyworth Nottingham NG12 5SU.	June 2024	£250,000	£87,500	£372.40	£25.33	
67	2 Bedroom End -Terrace House	21 Street Close Keyworth Nottingham NG12 5SU.	June 2024	£251,950	£88,183	£375.30	£25.33	

For further details please contact our sales team on: **0333 200 7304** or email: sales@platformhg.com

Contact Us:  www.platformhomeownership.com |  facebook.com/PlatformHomeOwnership

 twitter.com/PlatformNewHome |  instagram.com/platformhomeownership

For details contact our sales team
on **0333 200 7304**
or email: **sales@platformhg.com**

Contact Us:



www.platformhomeownership.com



facebook.com/PlatformHomeOwnership



twitter.com/PlatformNewHome



instagram.com/platformhomeownership

Scheme administered by Platform Housing Group
1700 Solihull Parkway, Birmingham Business Park, Solihull, B37 7YD.

Part of the **platform**
housing group