

GREAT OLDBURY

Stonehouse, Gloucestershire GL10 3WJ

3 & 4 BEDROOM
NEW HOMES

Welcome to
Great Oldbury,
situated on the
outskirts of the
village of
Stonehouse.



A COLLECTION OF 3 & 4 BEDROOM HOMES

Great Oldbury offers modern living in a vibrant rural environment.

Exciting new community on the edge of the Cotswolds, close to the market town of Stroud

This stunning new development offers homeowners contemporary living with a community feel for families, couples and first time buyers.

With its own local centre, purpose-built nursery, pre-school and Primary Academy, Great Oldbury is just a 5 minute drive from Stonehouse with its shops, pubs, restaurants, health and sports facilities. You will be ideally located to explore the Cotswolds with all it has to offer.

Junction 13 of the M5 is only one mile away giving easy access to Bristol, South Wales, the M4 and north to Gloucester and Cheltenham. The A419 links the area to the A38 and Severn Valley. Trains run from both Stonehouse and Stroud to London Paddington, Bristol, Cheltenham, Swindon and Reading.

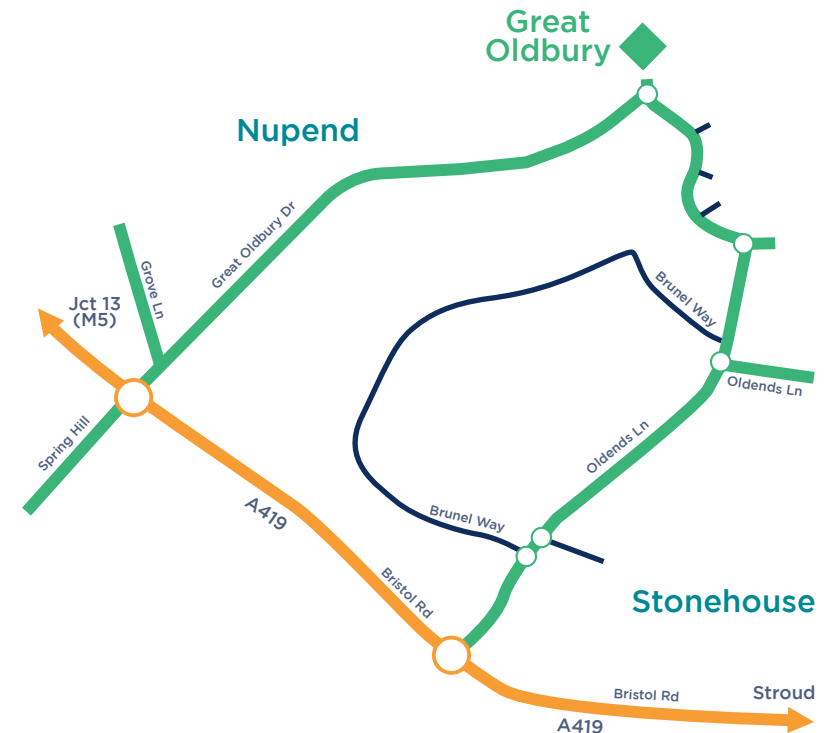

Please note: Car journey times shown are a average based on normal driving conditions.

Great Oldbury

Site Layout

◆ **The Becket**
3 Bed Detached
132

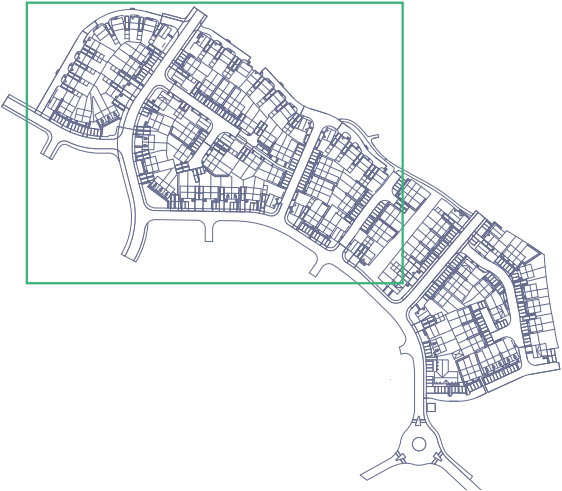



Computer generated image shown of plot 158.

The Becket

3 Bed Detached

The Becket is a stylish three bed double fronted new home comprising of a well appointed front aspect kitchen/dining, with rear spacious living area with French doors allowing easy access to the rear garden.

The first floor has three bedrooms and the family bathroom. The master bedroom benefiting from a En-Suite shower room.

SPECIFICATIONS

- ◆ 10 year build warranty
- ◆ Double glazed windows
- ◆ Downstairs W/C
- ◆ Family bathroom with shower over bath
- ◆ Gas central heating
- ◆ Modern fitted kitchen
- ◆ Turfed rear garden
- ◆ Allocated parking



GROUND FLOOR

Kitchen/Dining
5.64m x 2.98m 18'6" x 9'9"

Living
5.64m x 3.38m 18'6" x 11'1"

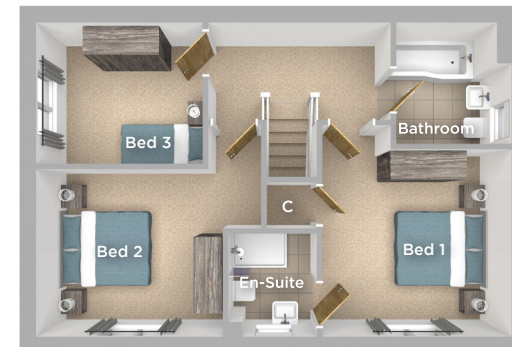

FIRST FLOOR

Bedroom 1
3.45m x 3.40m 11'4" x 11'2"

En-Suite
1.87m x 1.61m 6'2" x 5'3"

Bedroom 2
3.39m x 3.04m 11'71" x 9'11"

Bedroom 3
3.04m x 2.55m 9'12" x 8'4"

Bathroom
2.19m x 2.09m 7'2" x 6'10"

TOTAL FLOOR AREA
96.58m² - 1039.63 sq.ft

△ External access C Cupboard/Storage

Imagery indicative of Platform show homes. Fixtures and fittings shown are intended as a preliminary guide for prospective purchasers and should not be relied upon. Internal layouts show a general arrangement which may vary from plot to plot.

Platform Home Ownership have taken every effort to ensure that these documents are accurate and represent the properties available. Platform Home Ownership and the developer may in their efforts to improve design reserve the right to alter site plans, floorplans, elevations and specifications without prior notice. Visit our website at www.platformhomeownership.com for further details.

Great Oldbury

Stonehouse, Gloucestershire, GL10 3WJ.

House prices for all plots available



Plot	House Type	Postal Address	Handover	100% Price	40% Share Value	Monthly Rent	Service Charge
132	The Becket 3 Bed Detached House	29 Marling Way, Great Oldbury, Stonehouse, GL10 3WQ.	August 2024	£335,000	£134,000	£460.63	£36.19

For more information contact:

Sales@Platformhg.com

Platformhomeownership.com

0333 200 7304

Please note:

Prices and dates quoted above where correct at the time of going to print, Platform Home Ownership reserve the right to amend the details and prices above without prior consultation.

Purchasers are advised to consult with your sales co ordinator.





For more information contact:
Sales@Platformhg.com
Platformhomeownership.com
0333 200 7304



Stonehouse, Gloucestershire, GL10 3WJ.