



FOXBURY FIELDS

Harbury Lane, Leamington Spa
Warwickshire, CV33 9WH

2 & 3 Bedroom New Homes

PLATFORM HOME OWNERSHIP

At Platform Home Ownership, we're passionate about building quality homes for our customers and creating communities that homeowners can be proud of. It's our mission to build a better future for the UK - investing in affordable homes to ensure accessible routes to homeownership for everyone.

BUILDING A BETTER FUTURE THROUGH NEW HOMES





**WELCOME TO
FOXBURY FIELDS,
A STUNNING NEW
DEVELOPMENT,
ON THE OUTSKIRTS
OF THE POPULAR
REGENCY TOWN OF
LEAMINGTON SPA**



ABOUT SHARED OWNERSHIP

Buy your Foxbury Fields home through Shared Ownership.

Your dream home is more affordable than you may think with Shared Ownership.

Shared Ownership means you can purchase part of your home and then pay rent on the remaining share. Typically, you can purchase 40-75% of your home, but lower shares are available.

What's more, Shared Ownership is flexible, and allows you to increase your level of ownership over time if you choose to.

Whatever you're looking for, we have a wide selection of homes perfect for whatever your needs.

Buying through Shared Ownership at this development means you can purchase between 10-75% of your property and pay a subsidised rent on the remaining share you don't own.

HOW IT WORKS

STEP 1

Buy the first share in your new home

STEP 2

Pay rent on the remaining share

STEP 3

Buy more shares in your home later

DID YOU KNOW?

Shared Ownership offers great flexibility, and you can purchase more of your home through staircasing whenever you are ready too.

FOXBURY FIELDS IS WITHIN EASY REACH OF THE HISTORIC TOWN OF LEAMINGTON SPA.

A stunning collection of two and three bedroom homes available through Shared Ownership.

Foxbury Fields, is ideally located for commuters that work in and around the centre of Leamington and the surrounding Warwickshire area. If you need to travel further, junction 15 of the M40 is close by and Leamington offers a main train station.

The Regency town of Leamington has a rich heritage and a wealth of restaurants, pubs, cinema and various outdoor attractions to visit,

alternatively you are within 10 minutes commute to the historic market town of Warwick making it a great choice for families to visit.

Foxbury Fields is also within a short walk of a newly constructed award-winning school for the younger members of the family. A newly created country park area offers outdoor space to explore.



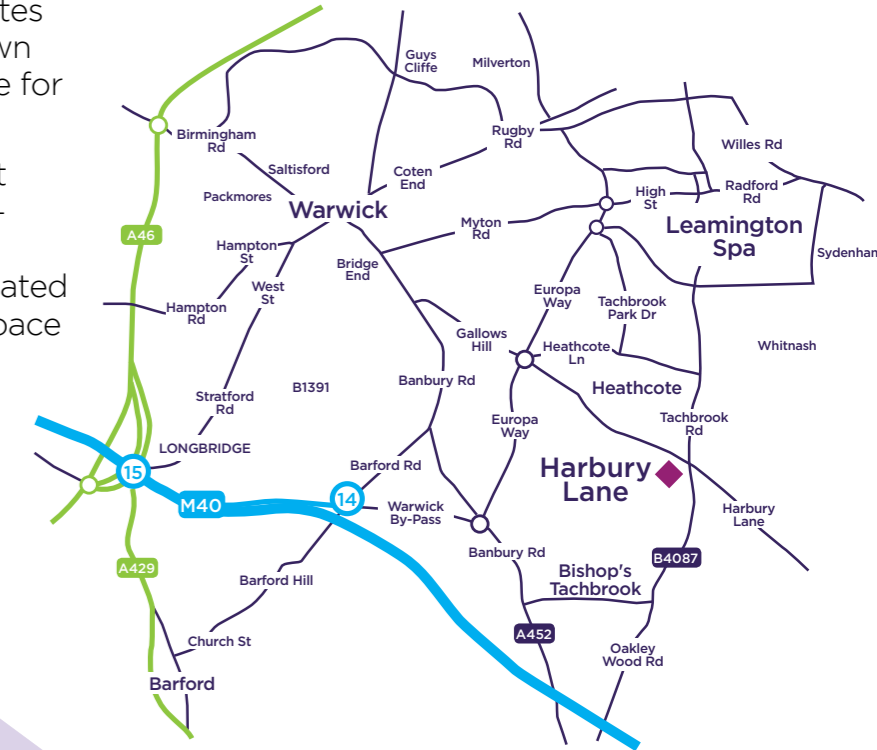

Please note: Car journey times shown are a average based on normal driving conditions.



FOXSBURY FIELDS SITE PLAN

SHARED OWNERSHIP

-  **The Shermont**
2 Bed Semi-Detached House
25, 26, 132, 133
-  **The Hayton**
3 Bed Semi-Detached House
37, 38





This image is from an imaginary viewpoint within an open space area. Its purpose is to give a feel for the development, not an accurate description of each property. The illustration shows a typical Platform Home Ownership home of this type, but there are, however, variances from site to site. External materials, finishes, landscaping, windows and the position of garages, (where provided) may vary throughout the development. Properties may also be built handed (mirror image). Please ask for further details.



GROUND FLOOR

Kitchen/Dining	4.02m x 3.63m	13'2" x 11'11"
Living	4.11m x 3.03m	13'6" x 9'11"
WC	1.69m x 1.27m	5'6" x 4'2"

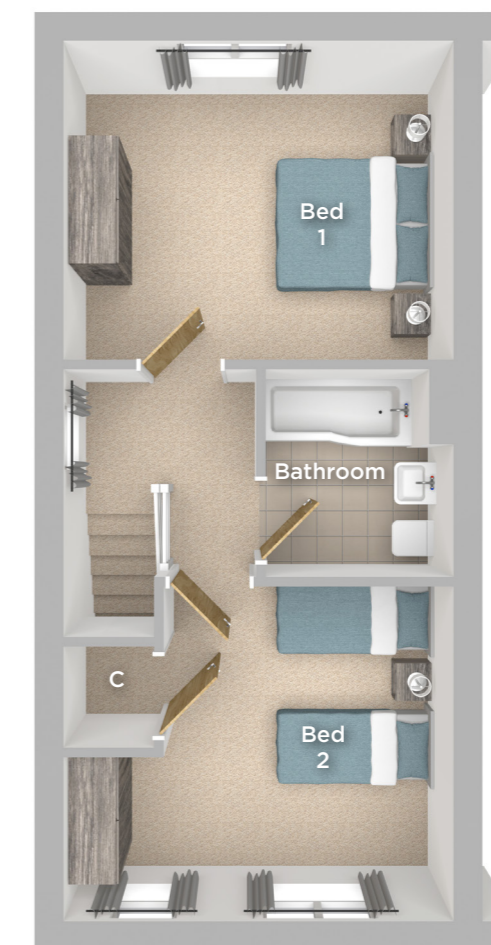

FIRST FLOOR

Bedroom 1	4.02m x 3.32m	13'2" x 10'11"
Bedroom 2	4.02m x 3.19m	13'2" x 10'6"
Bathroom	2.19m x 1.98m	7'2" x 6'6"

△ External access C Cupboard/Storage

THE SHERMONT

2 Bedroom Semi-Detached home

The Shermont is a stylish two bedroom semi-detached home comprising of a well appointed modern kitchen/dining layout with rear door access to the turfed garden and spacious front aspect living area.

Upstairs you will find two bedrooms and a white fitted family bathroom suite.

SPECIFICATIONS

- ◆ 10 year build warranty
- ◆ Modern fitted kitchen with oven, hob, extractor
- ◆ Downstairs W/C
- ◆ Family bathroom with shower over bath
- ◆ Vinyl floor to wet areas and kitchen
- ◆ EV Chargers
- ◆ ASHP (air source heat pump)
- ◆ Turfed & fenced rear garden
- ◆ Allocated parking

TOTAL FLOOR AREA
71.91m² - 774.00 sq.ft



This image is from an imaginary viewpoint within an open space area. Its purpose is to give a feel for the development, not an accurate description of each property. The illustration shows a typical Platform Home Ownership home of this type, but there are, however, variances from site to site. External materials, finishes, landscaping, windows and the position of garages, (where provided) may vary throughout the development. Properties may also be built handed (mirror image). Please ask for further details.



GROUND FLOOR

Kitchen/Dining	4.02m x 3.63m	13'2" x 11'11"
Living	4.11m x 3.03m	13'6" x 9'11"
WC	1.69m x 1.27m	5'6" x 4'2"

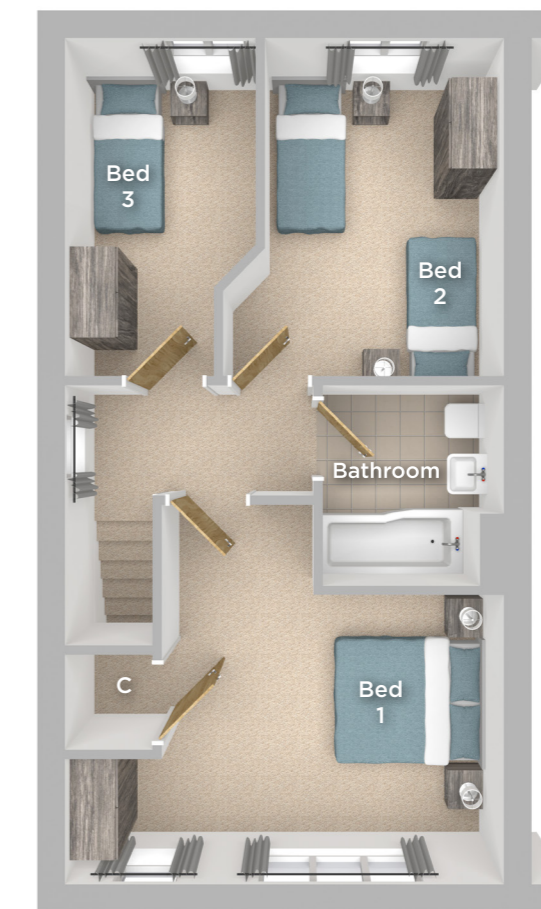

FIRST FLOOR

Bedroom 1	4.72m x 3.14m	15'6" x 10'4"
Bedroom 2	3.67m x 2.60m	12'0" x 8'6"
Bedroom 3	3.67m x 2.06m	12'0" x 6'9"
Bathroom	2.19m x 1.98m	7'2" x 6'6"

△ External access C Cupboard/Storage

THE HAYTON

3 Bedroom Semi-Detached home

The Hayton is a stylish three bedroom semi-detached home comprising of a well appointed modern kitchen/dining layout with double door access to the turfed rear garden and spacious front aspect living area.

Upstairs you will find three bedrooms and a white fitted family bathroom suite.

SPECIFICATIONS

- ◆ 10 year build warranty
- ◆ Modern fitted kitchen with oven, hob, extractor
- ◆ Downstairs W/C
- ◆ Family bathroom with shower over bath
- ◆ Vinyl floor to wet areas and kitchen
- ◆ EV Chargers
- ◆ ASHP (air source heat pump)
- ◆ Turfed & fenced rear garden
- ◆ Allocated parking

TOTAL FLOOR AREA
84.64m² - 911.00 sq.ft

FOXSBURY FIELDS, LEAMINGTON SPA

Warwickshire, CV33 9WH

House prices for all plots available



Plot	House Type	Postal Address	100% Price	30% Share Value	Monthly Rent	Service Charge
25	The Shermont 2 Bed Semi-Detached House	7 Glade Way, Bishops Tachbrook, Lemington Spa, Warwickshire, CV33 9FT.	£300,000	£90,000	£481.25	TBC
26	The Shermont 2 Bed Semi-Detached House	9 Glade Way, Bishops Tachbrook, Lemington Spa, Warwickshire, CV33 9FT.	£300,000	£90,000	£481.25	TBC
37	The Hayton 3 Bed Semi-Detached House	7 Forage Drive, Bishops Tachbrook, Lemington Spa, Warwickshire, CV33 9FU.	£340,000	£102,000	£545.42	TBC
38	The Hayton 3 Bed Semi-Detached House	9 Forage Drive, Bishops Tachbrook, Lemington Spa, Warwickshire, CV33 9FU.	£340,000	£102,000	£545.42	TBC
132	The Shermont 2 Bed Semi-Detached House	18 Glade Way, Bishops Tachbrook, Lemington Spa, Warwickshire, CV33 9FT.	£300,000	£90,000	£481.25	TBC
133	The Shermont 2 Bed Semi-Detached House	16 Glade Way, Bishops Tachbrook, Lemington Spa, Warwickshire, CV33 9FT.	£300,000	£90,000	£481.25	TBC

For more information contact:
Sales@Platformhg.com
Platformhomeownership.com
0333 200 7304

Please note: Prices and dates quoted above where correct at the time of going to print, Platform Home Ownership reserve the right to amend the details and prices above without prior consultation. Purchasers are advised to consult with your sales co ordinator.





**BUILDING HOMES FOR
A BETTER FUTURE**

GET IN TOUCH

 Sales@Platformhg.com

 Platformhomeownership.com

 0333 200 7304



Harbury Lane, Leamington Spa
Warwickshire, CV33 9WH.